

Northfield Library

Option 1: Expand into Basement

Northfield • Site Context Showing Proposed Traffic Circle



Northfield • Expand into Basement

All diagrams are preliminary. Agreements with local governments are required. Cost estimates are to be developed after concepts refined based on community feedback.

FIRST FLOOR = YOUTH SERVICES & MARKETPLACE

➤ Increased Useable Area

- Enter at “civic” corner
- Improved sight lines
- Improved flow throughout the space

➤ Marketplace

- Improved browsing experience for new items and staff displays
- Allows for quick grab & go
- Mix of adult & youth materials

➤ Improved Youth Services

- More space for books, seating, interactives
- Flexible Storytime/Programming Room
- Easier access for parents/caregivers with multiple children, strollers

➤ Improved Staff Area

- Staff workroom is right-sized, relocated and linked to delivery door, mezzanine, and lower level

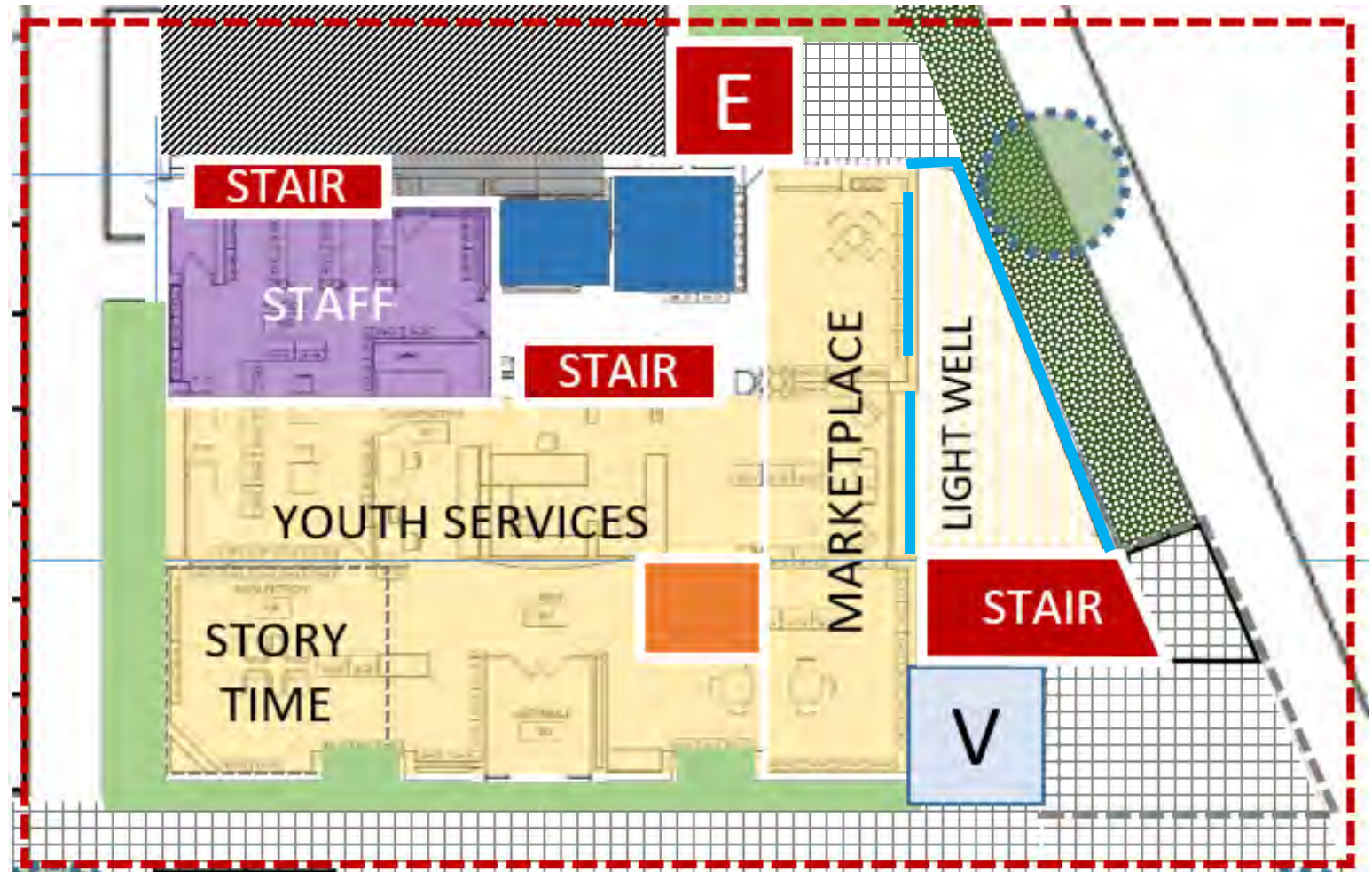

						F		
VESTIBULE	PUBLIC SPACE	STUDY ROOM	REST ROOM	SERVICE POINT	STORAGE EQUIPMENT	FIREPLACE	STAIR OR ELEVATOR	STAFF SPACE

1ST FLOOR DIAGRAM



Northfield • Expand into Basement

All diagrams are preliminary. Agreements with local governments are required. Cost estimates are to be developed after concepts refined based on community feedback.

LOWER LEVEL = ADULT SERVICES, STUDIO, STUDY ROOMS, MEETING ROOM

➤ Increased Useable Area

- Uses existing space
- Connects to first floor with an elevator and staircase
- Improved ADA compliance
- Provides additional restrooms

➤ Improved Adult Services

- Noise separation from Youth Services
- Cozy reading area with enclosed “Lightwell” to bring in light and relocated fireplace
- More books, more seating
- Multiple Study Rooms
- Divisible Multi-Purpose Room can function as one large space or two smaller spaces
- Multi-Purpose room can also be used for Studio programming

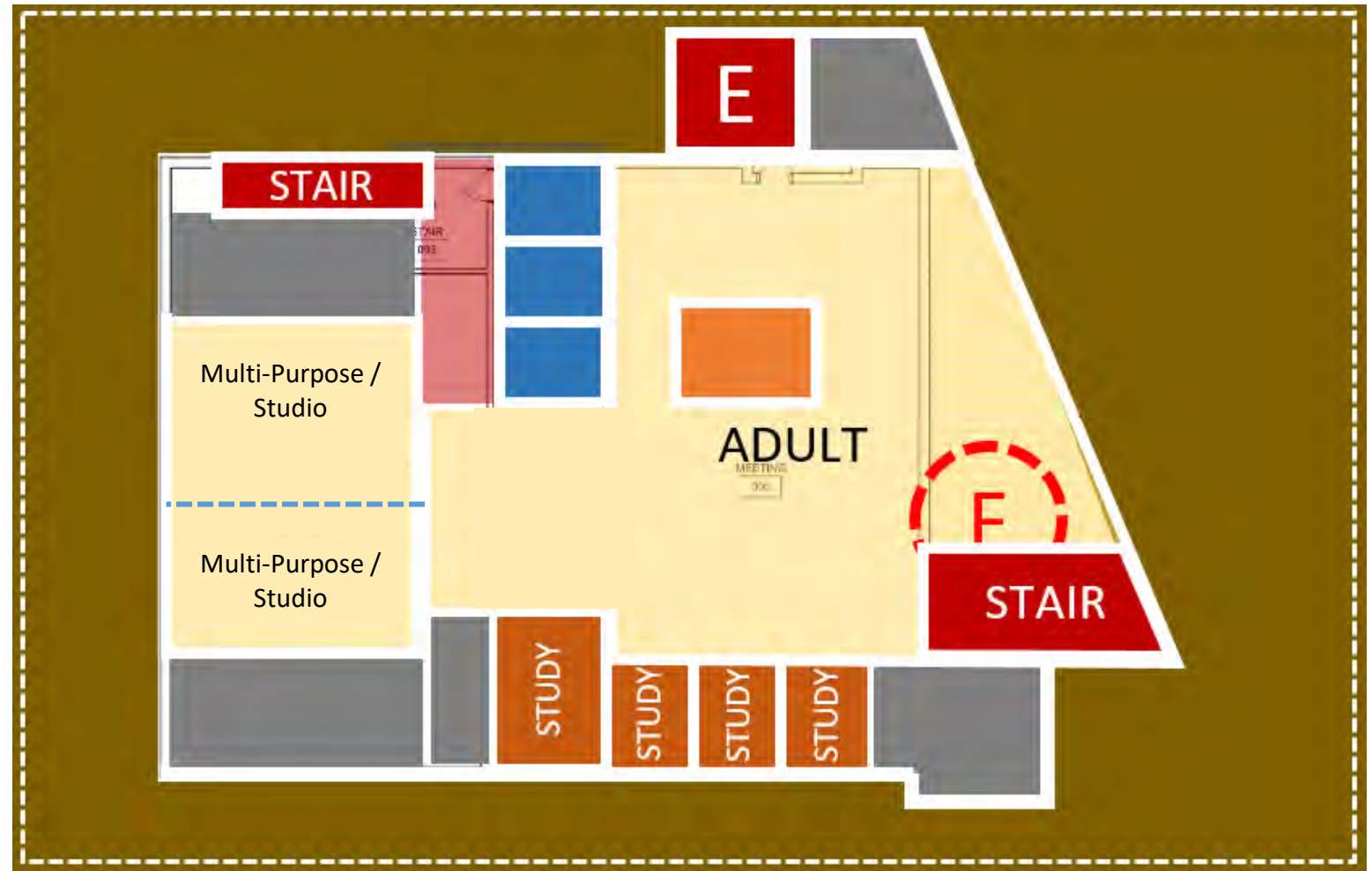

						F		
VESTIBULE	PUBLIC SPACE	STUDY ROOM	REST ROOM	SERVICE POINT	STORAGE EQUIPMENT	FIREPLACE	STAIR OR ELEVATOR	STAFF SPACE

LOWER LEVEL DIAGRAM

